



Innovation

Simply better.

Distributed by:



FROM **37⁵⁹**

TW...-2K



TW...K



TW...H



Welding table clamp, fixed throat depth TW

- Precise, individual clamping with variable height and fixed throat depth.
- Tempered profile and sliding arm for strong, dependable, clamping.
- Available: 2-component plastic handle; T-Bar (each with smooth-running ACME threaded spindle and tool free pressure plate replacement); or lever handle with a ratcheting mechanism for controlled, fast and vibration-proof clamping.

	Handle Style	Hole Diameter	Clamping Capacity	Nominal Throat Depth	Rail Profile	Clamping Force	Price
NEW	TW16-20-10-2K	Composite	16 mm	8"	4"	7/8" - 3/8"	650 lbs \$37.59
NEW	TW16-20-10K	T-Bar	16 mm	8"	4"	7/8" - 3/8"	650 lbs \$37.59
NEW	TW16-20-10H	Lever	16 mm	8"	4"	7/8" - 3/8"	650 lbs \$65.70
	TW28-30-14-2K	Composite	28 mm	12"	5 1/2"	1 1/8" - 7/16"	1100 lbs \$51.99
	TW28-30-14K	T-Bar	28 mm	12"	5 1/2"	1 1/8" - 7/16"	1100 lbs \$51.99
	TW28-30-14H	Lever	28 mm	12"	5 1/2"	1 1/8" - 7/16"	1100 lbs \$87.99

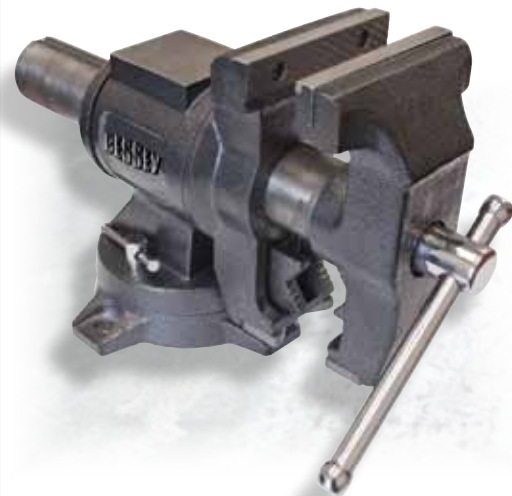

Multi-purpose vise (rotating pipe and bench vise)

- Simply bolt to the bench's top surface and lock workpiece in place with heavy duty jaws
- Base swivels 360°
- 3 mounting holes and 2 lockdowns
- Pipes are no problem – serrated jaws rotate 360°
- Made with a cast iron body for durability
- Built-in anvil

109⁹⁹

Vise Video



	Jaw Width	Jaw Opening	Throat Depth	Pipe Capacity	Price
BV-MPV5	5"	5"	3"	2"	\$109.99



FROM **80⁹⁹**

Heavy duty (100 Series) C-clamps

- Designed specifically for heavy duty applications.
- Square head on the T-handle.



	Clamping Capacity	Throat Depth	Clamping Force	Price
B-103	0-3"	2"	8,750 lbs	\$80.99
B-104	0-3 1/2"	2 1/4"	10,000 lbs	\$90.99
B-106	2-5 1/2"	2 1/2"	11,250 lbs	\$109.99



NEWSLETTER SIGN UP!

Email us at info@besseytools.com to request sign-up, or scan the QR code!

Join us on...

www.facebook.com/BesseyToolsNorthAmerica

www.twitter.com/BesseyTools

www.youtube.com/user/BesseyTools

www.besseytools.com/



Bar clamps for industrial application

Regular duty all-steel bar clamp (SQ Series)

- Top selling BESSEY® series
- A great mixture of size and strength, representing a top bar clamp
- Comes with standard rail profile, heavy duty pad

	Clamping Capacity	Throat Depth	Clamping Force	Price
SQ-8	8"	5 1/2"	2660 lbs	\$87.56
SQ-16	16"	5 1/2"	2660 lbs	\$136.04
SQ-24	24"	5 1/2"	2660 lbs	\$184.36



FROM **87⁵⁶**



Auto-adjust jaw height = rapid clamping

A range of applied force & height in one clamp: the power to be in position fast

Features:

- 1 Auto-adjustment of the jaw height**
Self adjusts to variations in workpiece height while maintaining clamping force.
- 2 Adjustable clamping force**
The integrated clamping force adjustment screw can vary the applied clamping force in a range.
- 3 Adaptable base plate:**
Holes sized and spaced for easy mounting in metric & imperial.
- 4 Large ergonomic handle**
Soft insets for maximum comfort.



FROM **20⁴⁹**

Toggle Video



Vertical toggle with open arm and horizontal base plate

Model #	Opening	Nominal Clamping Force Range	Holding Capacity	Fastener	Price
STC-VH20	0-13/16"	25 - 250 lbs.*	450 lbs.	3/16" or M5	\$21.49
STC-VH50	0-1 9/16"	25 - 550 lbs.*	700 lbs.	1/4" or M6	\$22.46

Horizontal with flanged base

Model #	Opening	Nominal Clamping Force Range	Holding Capacity	Fastener	Price
STC-HH20	0-13/16"	25 - 250 lbs.*	450 lbs.	3/16" or M5	\$20.49
STC-HH50	0-1 9/16"	25 - 550 lbs.*	700 lbs.	1/4" or M6	\$21.99
STC-HH70	0-2 3/8"	25 - 550 lbs.*	700 lbs.	1/4" or M6	\$22.99

Inline with flanged base/angled base

Model #	Opening	Nominal Clamping Force Range	Holding Capacity	Fastener	Price
STC-IHH25	0-5/8"	25 - 550 lbs.*	700 lbs.	1/4" or M6	\$23.99



Snips & knives



FROM **36⁹⁷**

Offset snips, optimized (D29ASS-2)

- High grade steel cutting blade, compact cutting head
- Use 25% less effort with the optimized leverage
- Right or left cutting versions available
- HRC up to 61.



	Overall Length	Blade Length	Cutting Capacity (carbon steel)	Price
D29ASS-2	10 1/4"	1 5/16"	18 gauge	\$36.97
D29ASSL-2	10 1/4"	1 5/16"	18 gauge	\$36.97

Folding utility knife

FROM **18⁹⁹**

- Folding / locking blade with belt-clip
- Uses standard blades
- Easy change quick blade exchange mechanism
- Spring blade release
- Wood handle

	Overall Length	Blade Length
D-BKWH	6 1/4"	2 1/4"



EZ One-handed clamping or spreading

Another powerhouse from BESSEY®. Built with internal components that reflect German engineering, EZ transitions smoothly from clamping to spreading.

NEW

- Internal components with German engineering – heavy duty!
- Intelligent release mechanism – upper section quickly converts from clamping to spreading
- Ergonomically shaped 2-component plastic handle with pump positioned behind the rail, for a powerful grip
- Soft pressure caps
- Throat depth to the very edge – with it's power spread across the entire pad, EZS's throat depth extends right to the outside edge of the pads!



FROM
14⁹⁹



	Clamping Capacity	Throat Depth	Clamping Force	Price
EZ15-6	6"	2 3/4"	150 lbs	\$14.99
EZ30-6	12"	2 3/4"	150 lbs	\$16.69

Seaming tools

Extra large solid surface seaming tool (PS)

- Twin vacuum cups for clamping non-porous, solid surface material such as granite, marble, corian, plastic or glass.
- Vacuum operating button activates and locks the vacuum seal on the work surface
- Steel spindle smoothly draws the seams together with just the right pressure
- Guide rails create a solid, rigid frame to support vacuum cup

	Clamping Capacity	Cup Diameter	Clamping Force	Price
PS130	3 1/8"	8 1/4"	265 lbs	\$369.99



369⁹⁹



Floor tools



11⁹⁹

AV2 Spacer (set of 4)

- Lay solid wood and laminate flooring without wedges. Insert between wall and first row of flooring for a fast, simple, set up.
- "Clever dial" the distance to the wall.
- Removal is a quick turn of the dial to release pressure.
- Exact millimetre scale compensates for wall surface irregularities of 5 to 20 mm.
- "Robust" in the size of a business card.

	Opening Range	Jaw Width	Price
AV2	3/16" - 1/16"	3 1/2"	\$11.99

Spring clamps



Clippix® ratcheting spring clamp set (XCR)

- Heavy duty resin construction
- Ratcheting mechanism for quick action, quick release
- Pivoting jaws for a snug fit

	Includes	Price
XCR-4PC	4 x 2" clamps	\$16.98



16⁹⁸



Steel spring clamps (XM)

- Made with vinyl tips to prevent marring and vinyl handles for a non-slip grip.
- Features a heavy duty spring for a tight fit and nickel plating to prevent corrosion.

	Clamping Capacity	Throat Depth	Price
XM3	1"	1 1/4"	\$2.39
XM5	2"	2 1/4"	\$3.38
XM7	3"	3 3/16"	\$5.98
XM10	4"	5"	\$15.88



FROM
2³⁹



Innovation

Simply better.

Distributed by:

NEW

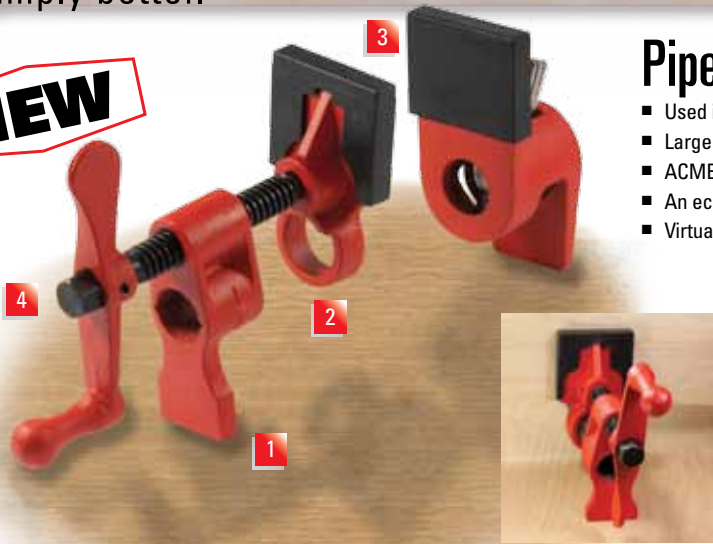

Pipe clamp, traditional style (PC-2)

- Used in woodworking applications for edge gluing of multiple pieces
- Large clamping surface
- ACME threaded screw
- An economical alternative to the bar clamp
- Virtually limitless clamping capacity determined by the length of pipe used

Features and benefits at a glance:

- 1 **Foot assembly** stabilizes clamp
- 2 **Extra high base** – finger-saving clearance from work surface
3. **Cast jaws** for durability
4. **Smooth action spindle with Hex head***

	Black Pipe Diameter	Price
PC34-2	3/4"	\$14.99
PC12-2	1/2"	\$12.99

FROM **12⁹⁹**

*Hex head spindle is to facilitate clamping, not augment it. Applying too much clamping force may cause the fixture to fail.

NEW



Track/table clamp (GTR)

NEW innovative clamp designed for holding materials safely & securely on MDF tables equipped with matrix holes & T-tracks. Manufactured from the highest-grade materials.

Features and benefits at a glance:

- 1 **Special lower arm** for 12 x 8 mm grooves.
- 2 **Safety by design** Track saw guide slots for secure, fast clamping. High clamping force for increased safety.
- 3 **Versatility** For use with Festool, Protool, Metabo, Makita, DeWalt track saw guides.
- 4 **Wood handle or lever handle with ratchet action**

Wooden handle track/table clamp (GTR)

	Clamping Capacity	Throat Depth	Nominal Clamping Force	Price
GTR12	4 1/16"	2 5/16"	400 lbs	\$29.99

FROM **29⁹⁹**

Lever handle track/table clamp (GTRH)

- Variable clamping force, with ratchet action lever, up to 5 times faster than conventional clamps
- Secure – lever / ratchet unaffected by vibrations
- Strong – nominal clamping force up to 540 lbs

	Clamping Capacity	Throat Depth	Nominal Clamping Force	Price
GTR16S6H	6 5/16"	2 5/16"	540 lbs	\$44.95



Wood handscrew clamps (HS)

- Perfect for gluing; adjustable jaws for a strong or delicate grip
- Oiled wooden jaws won't damage or slip on workpiece
- Wood handscrew clamp is held together by cold-drawn, carbon-steel spindles and swivel nuts
- Large handles for comfort and torque

13⁹⁸

	Jaw Length	Clamping Capacity	Throat Depth	Spindle Diameter	Price
LHS10	10"	7"	6"	7/16"	\$13.98



NEWSLETTER SIGN UP!

Email us at info@besseytools.com to request sign-up, or scan the QR code!



Join us on...

www.facebook.com/BesseyToolsNorthAmerica
www.twitter.com/BesseyTools
www.youtube.com/user/BesseyTools
www.besseytools.com/

